



RURAL MUNICIPALITY OF SARNIA NO-221, SASKATCHEWAN

FIGURE 1

 Area of knolls and depressions in glacial drift (moraine) in which water is obtained from scattered pockets of sand and gravel at depths of 90 feet or less

 Glacial till or boulder clay (till plain) in which water is obtained from scattered pockets of sand and gravel at depths of 205 feet or less

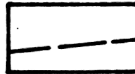
 Boundary of area in which Flowing Artesian wells occur

NOTE:
The Marine Shale series is thought to underlie the glacial drift throughout the municipality



Map showing the surface and bedrock geology as it affects the supply of ground water, and areas in which the ground water occurs

FIGURE 2

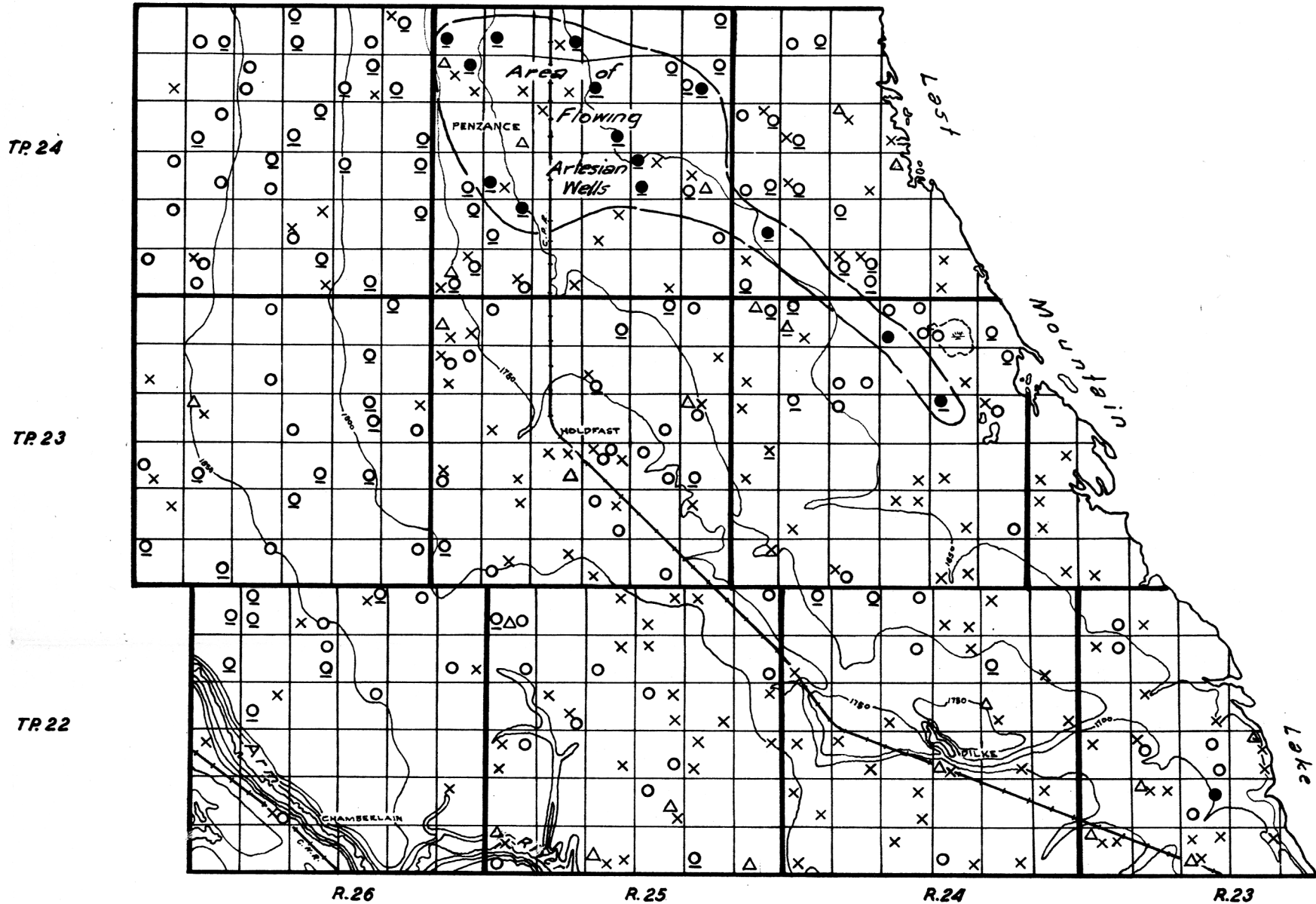

Map showing the drainage and relief, and the location and types of wells with source of ground water supply



Well class 1
In drift In bedrock

Flowing wells (These are usually designated as Flowing Artesian wells)



Well class 2
In drift In bedrock

Wells in which the water is under pressure but does not rise to the surface (These are usually designated as Non-flowing Artesian wells)



Well class 3
In drift In bedrock

Wells in which the water does not rise above the water table (These are usually designated as Non-Artesian wells)



Dry holes
In drift In bedrock

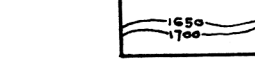

Contours (interval 50 feet)

0 3 6 9 12 15 18
Scale of miles

This document was produced
by scanning the original publication.

Ce document est le produit d'une
numérisation par balayage
de la publication originale.